

**Dodge Durango
Chrysler Aspen**

**51067
44173**

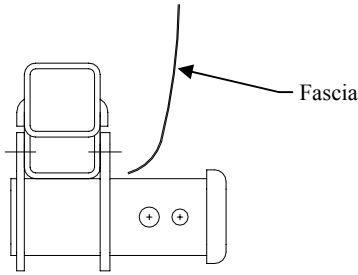

**Do Not Exceed Lower of Towing Vehicle
Manufacturer's Rating or**

Hitch type	Max Gross Trailer WT (LB)	Max Tongue WT (LB)
Weight Distributing	7500 (3405 Kg)	750 (341 Kg)
Weight Carrying Ball Mount	5000 (2270 Kg)	500 (227 Kg)

Hitch Shown In Proper Position

Equipment Required: Pull wire (Provided), "C" Clamp

Wiring Access Location: SUV1, SUV2

Fastener Kit: 51067F

Wrenches: 7/8

Drill Bits: 1/2"

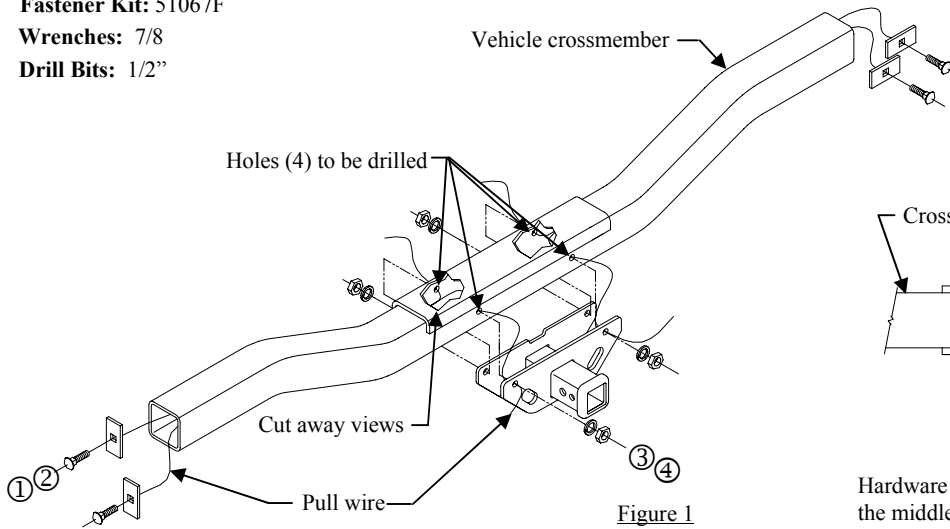

Figure 1

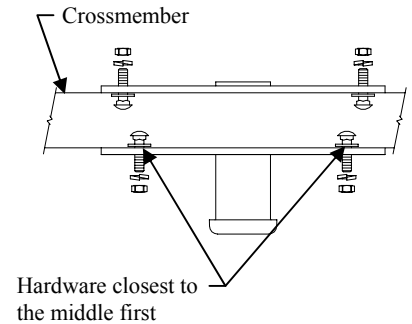

Figure 2

①	Qty. (4)	Carriage Bolt 1/2-13 X 1.50	③	Qty. (4)	Lock Washer 1/2
②	Qty. (4)	Spacer	④	Qty. (4)	Hex Nut 1/2-13

- Lower spare tire.
- Remove the (4) fasteners which secure fascia to fascia mounting brackets. Push fascia up to allow access to vehicle's crossmember.
- Raise hitch into position and center it on vehicle.
- Secure tightly in place with "C" clamp(s). Making sure the hitch assembly is up tight to the bottom of the vehicle's crossmember.
- Using the hitch as a guide, drill (4) holes (1/2 inch dia.) into the crossmember.
Note: Install the hardware into the holes that are closest to the middle of the vehicle first. (See Figure 2.)
- Insert pull wire (coiled end) through hitch and the drilled hole in the crossmember until the pull wire comes out the open end of the crossmember. Slide block over the coiled end and attach carriage bolt. Carefully pull the hardware through the crossmember as shown.
- Remove the pull wire and install lock washer and nut finger tight onto the carriage bolt. Repeat this step (3) more times to install the remaining hardware.
- Replace the (4) fasteners which secure fascia to fascia mounting brackets that were previously removed in step number 2.
- Raise spare tire back into position.

Tighten all 1/2-13 GR8 fasteners with torque wrench to 106 Lb.-Ft. (144 N*M)

Note: check hitch frequently, making sure all fasteners and ball are properly tightened. If hitch is removed, plug all holes in trunk pan or other body panels to prevent entry of water and exhaust fumes. A hitch or ball which has been damaged should be removed and replaced. Observe safety precautions when working beneath a vehicle and wear eye protection. Do not cut access or attachment holes with a torch.

This product complies with safety specifications and requirements for connecting devices and towing systems of the state of New York, V.E.S.C. Regulation V-5 and SAE J684.