

## NOTES

1

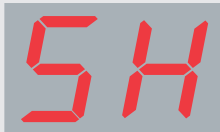

If "SH" displays, check connections and retest. If there is no change, the module has failed.

2

3

**FOR ASSISTANCE CALL:  
WELLS MANUFACTURING, L.P.  
1-800-558-9770  
FOR CUSTOMER SERVICE**

### STEP 1: FIND CORRECT LEAD WIRE

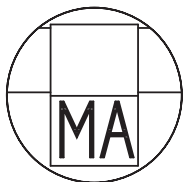

### STEP 3: CONNECT TO TESTER

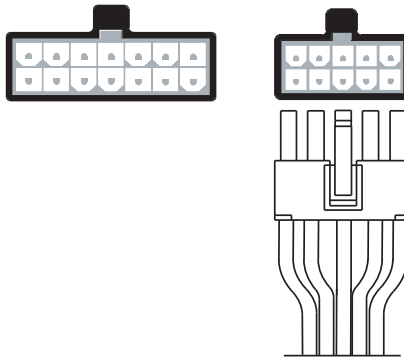

### STEP 4: SETTING UP TESTER

Enter product select number "08" and press start to begin test.



### STEP 2: MAKE CONNECTIONS TO PART (CR100)

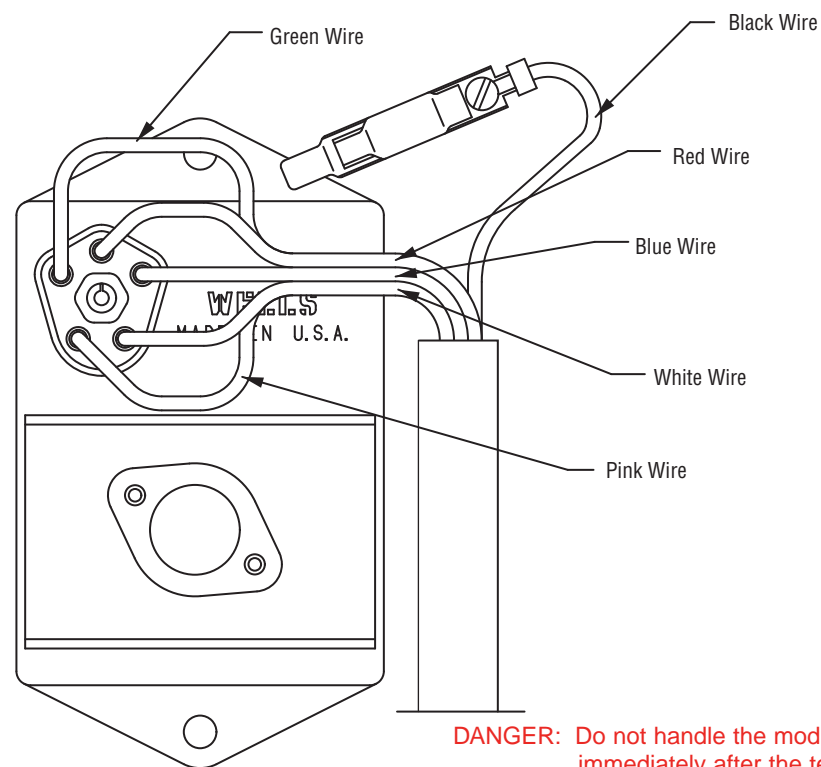

**DANGER:** Do not handle the module during or immediately after the test sequence, as electrical shocks and burns may occur.

**Battery Positive From  
Ignition Switch**

**Ignition Coil Negative  
Input Signal Positive**

**No Connection**

**Input Signal Negative**

**Case Ground**



WHEELS  
ENGINE MANUFACTURER