

IDLE SPEED CONTROL ACTUATOR

TOOLS REQUIRED:

- 9-VOLT ALKALINE BATTERY
- 2 JUMPER WIRES
- 2 SMALL WHITE TESTER LEADS (ROUND OR FLAT)
- SENSOR TESTER

2 TEST PROCEDURES REQUIRED

TEST PROCEDURE #1 MOTOR TEST

1. CONNECT A JUMPER WIRE FROM THE 9-VOLT BATTERY POSITIVE TERMINAL TO THE FEMALE END OF A SMALL WHITE TESTER LEAD. CONNECT THE MALE END OF THE SMALL WHITE TESTER LEAD TO TERMINAL "D" OF THE ISC ACTUATOR.
2. CONNECT A SECOND JUMPER WIRE FROM THE 9-VOLT BATTERY NEGATIVE TERMINAL TO THE FEMALE END OF ANOTHER SMALL WHITE TESTER LEAD. CONNECT THE MALE END OF THE SMALL WHITE TESTER LEAD TO TERMINAL "C" OF THE ISC ACTUATOR. WHEN CONNECTED, THE NOSE PLUNGER SHOULD FULLY EXTEND AND CLICK RAPIDLY.
3. REPEAT STEPS 1 AND 2, BUT REVERSE THE LEADS (POLARITY) TO THE "C" AND "D" TERMINALS. THE NOSE PLUNGER SHOULD FULLY RETRACT.

NOTE: IF THE NOSE PLUNGER FAILS TO EITHER FULLY EXTEND OR RETRACT, THE ISC ACTUATOR IS FAULTY AND SHOULD BE REPLACED.

4. WITH THE NOSE PLUNGER FULLY RETRACTED, PRESS IT INWARD. IT SHOULD NOT MOVE. IF IT DOES MOVE, THE ISC ACTUATOR IS FAULTY AND SHOULD BE REPLACED.
5. USING STEPS 1 AND 2, RE-EXTEND THE NOSE PLUNGER TO APPROXIMATELY HALF ITS LENGTH.

(SEE NEXT PAGE FOR TEST PROCEDURE #2)

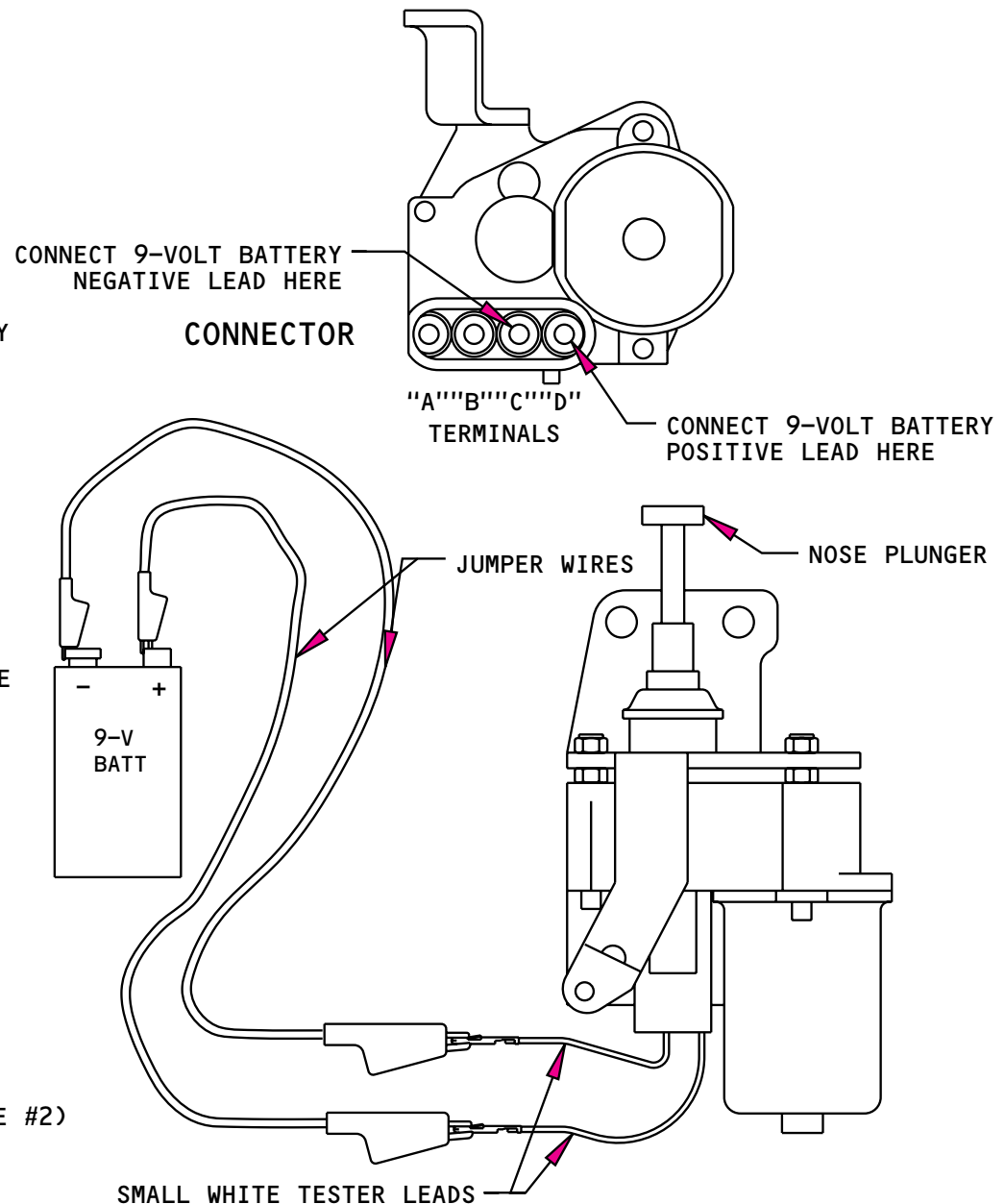

IDLE SPEED CONTROL ACTUATOR (CONTINUED)

TEST PROCEDURE #2 - NOSE PLUNGER TEST

1. TURN THE SENSOR TESTER ON AND SET IN THE "SENSOR/MODULE" FUNCTION.
2. CONNECT THE SENSOR TESTER BLACK LEAD TO THE FEMALE END OF A SMALL WHITE TESTER LEAD. CONNECT THE MALE END OF THE SMALL WHITE TESTER LEAD TO TERMINAL "A" OF THE ISC ACTUATOR.
3. CONNECT THE SENSOR TESTER YELLOW LEAD TO THE FEMALE END OF ANOTHER SMALL WHITE TESTER LEAD. CONNECT THE MALE END OF THE SMALL WHITE TESTER LEAD TO TERMINAL "B" OF THE ISC ACTUATOR.
4. PRESS THE NOSE PLUNGER INWARD: THE TWO RED LIGHTS ON THE TESTER SHOULD COME ON. RELEASE THE PLUNGER: THE LIGHTS SHOULD GO OFF. IF THEY DON'T, THE ISC ACTUATOR IS FAULTY AND SHOULD BE REPLACED.

