



**FORCE II™**  
**SYSTEM #17272**  
**1991-1995 JEEP WRANGLER YJ**  
**4.0L ENGINES**

9/10/09

**Removal:**

- 1) Raise the vehicle up on a hoist or rack to working height.
- 2) Using a hacksaw or sawsall, cut the stock tailpipe where it exits the muffler. *(This step makes it easier to remove under vehicle.)*
- 3) Separate the wire hanger on the tailpipe from its rubber mount on the vehicle. Remove the tailpipe and set aside.
- 4) Support the muffler with a stand and remove the muffler clamp at the catalytic converter to muffler connection.
- 5) Remove the muffler assembly from under the vehicle. *(Note: Heating the inlet pipe connection with a torch may ease removal. USE EXTREME CAUTION.)*

**Installation:**

- 1) Before installing anything, prep the clamps supplied in the hardware kit by removing the nuts, and applying a thick lubricant such as white grease or anti-seize to the threads.
- 2) Connect the clamp/hanger assembly **#235HA** to the rubber mount in the muffler location on the vehicle.
- 3) Raise the muffler **#952462-144** into position and connect to the outlet of the catalytic converter. *(Be sure to install the muffler inlet forward.)* Connect the previously installed hanger assembly with the muffler outlet to support it. Install a 2 1/4" clamp on the inlet end of the muffler and tighten lightly.
- 4) Place pipe **#16279** in position over the rear axle. Slip into the rear of the muffler and connect the hanger to the rubber mount. Install a 2 1/4" clamp and tighten lightly.
- 5) Adjust the position of the pipes and muffler to achieve satisfactory fit. *(The muffler will sit flat.)* Be sure to allow adequate clearance for suspension travel, vibration, etc.
- 6) Tighten down all clamped connections securely. Slide the provided hanger keepers onto the hangers to prevent them from sliding out of the rubber mounts.
- 7) For a cleaner appearance and more secure installation, we highly recommend welding all slip-fit connections. If you live in a geographical area that has harsh winters or sees a great deal of precipitation, the use of high temperature paint over the welded areas can help to prevent surface rust and premature corrosion.



Installation diagram for:  
**SYSTEM #17272**  
 1991-1995 JEEP WRANGLER YJ  
 4.0L ENGINES

**FORCE II™**

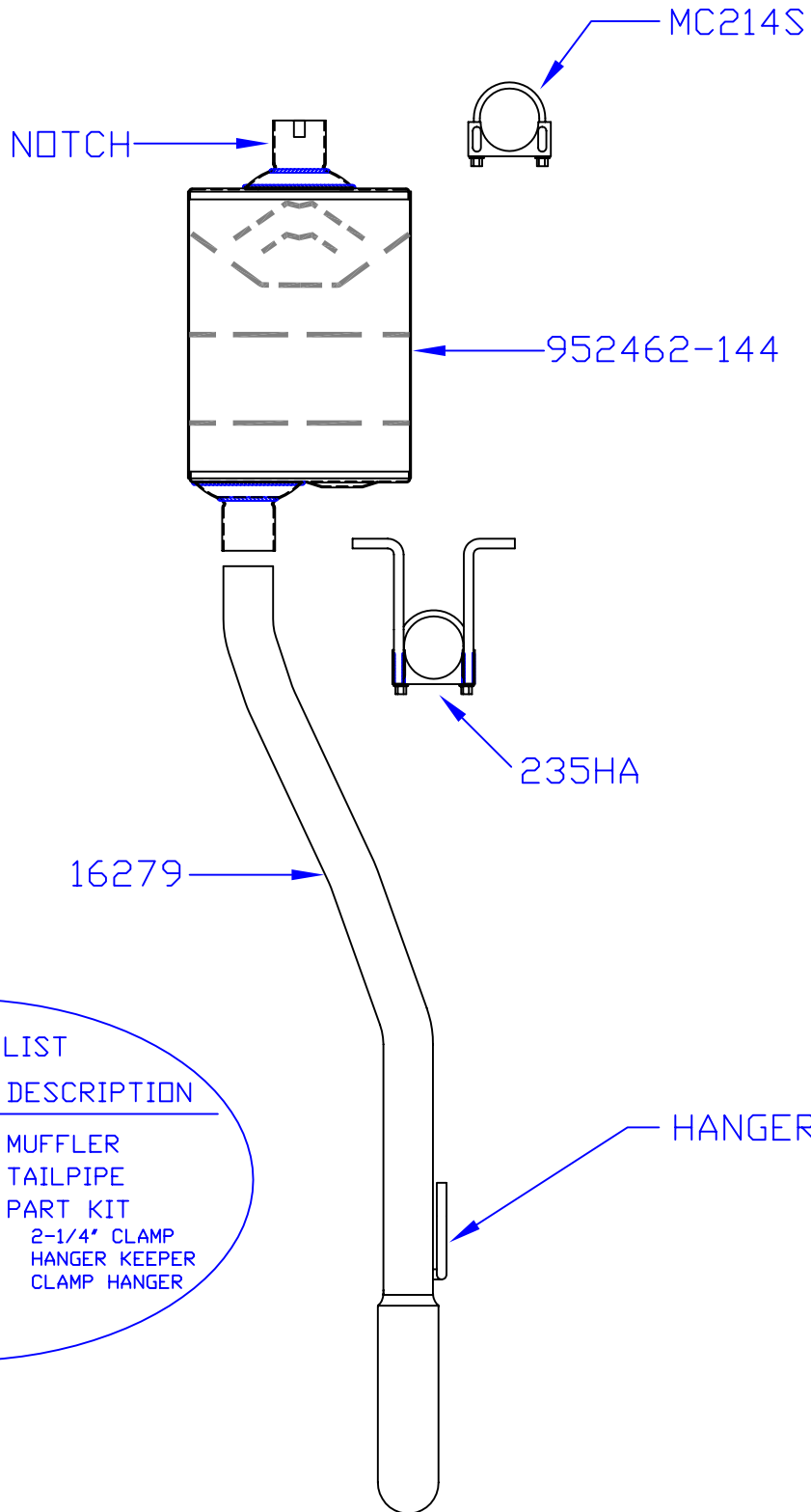

PACKING LIST

QTY.	PART#	DESCRIPTION
1	952462-144	MUFFLER
1	16279	TAILPIPE
1	PK352	PART KIT
1	MC214S	2-1/4" CLAMP
2	7/16"	HANGER KEEPER
1	235HA	CLAMP HANGER