

# INSTRUCTION SHEET FOR SET #7-1102

Read this instruction sheet thoroughly before initiating any work!

**ENERGY**  
**SUSPENSION**

1131 VIA CALLEJON, SAN CLEMENTE, CA 92673

**NOTE:** Original shell must be reused. Do not remove shell from the eye of the mustache bar. With the bar removed from the vehicle, use heat to de-bond the rubber from the shell. This inside area of the shell must be cleaned of all old rubber before installing the new urethane bushings.

**IMPORTANT:** Apply a light coat of supplied grease to the I.D. of the shell. Apply a light coat of grease to the I.D., O.D. and flange of the bushings.

© 2003 Energy Suspension. All rights reserved.  
May not be reproduced, in any form, or by any means,  
without the written consent of Energy Suspension.

012303NJT

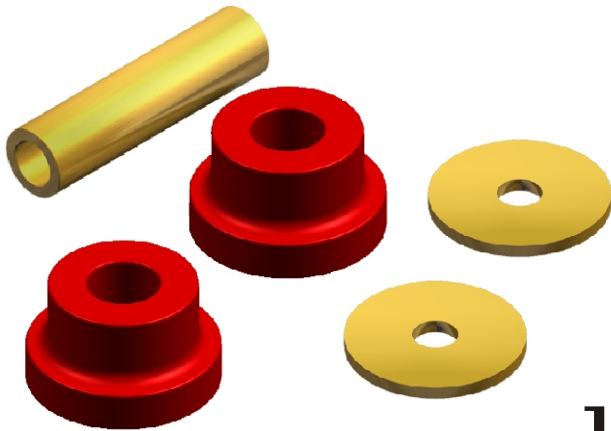

17064

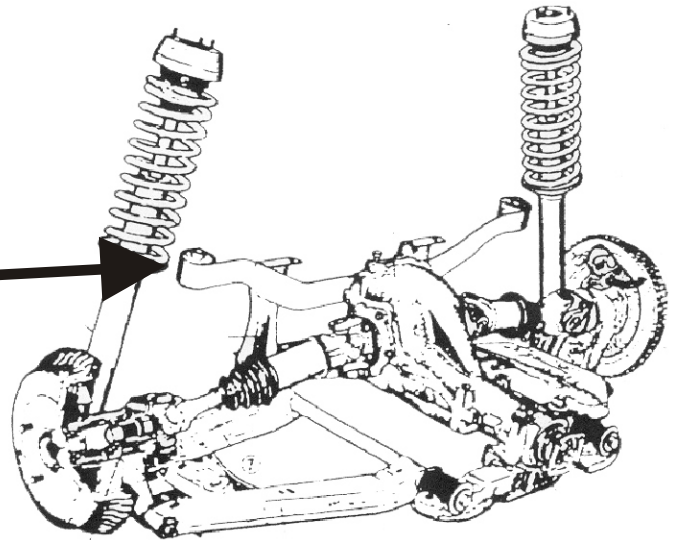

# INSTRUCTION SHEET FOR SET #7-1102

Read this instruction sheet thoroughly before initiating any work!

**ENERGY**  
**SUSPENSION**

1131 VIA CALLEJON, SAN CLEMENTE, CA 92673

**NOTE:** Original shell must be reused. Do not remove shell from the eye of the mustache bar. With the bar removed from the vehicle, use heat to de-bond the rubber from the shell. This inside area of the shell must be cleaned of all old rubber before installing the new urethane bushings.

**IMPORTANT:** Apply a light coat of supplied grease to the I.D. of the shell. Apply a light coat of grease to the I.D., O.D. and flange of the bushings.

© 2003 Energy Suspension. All rights reserved.  
May not be reproduced, in any form, or by any means,  
without the written consent of Energy Suspension.

012303NJT

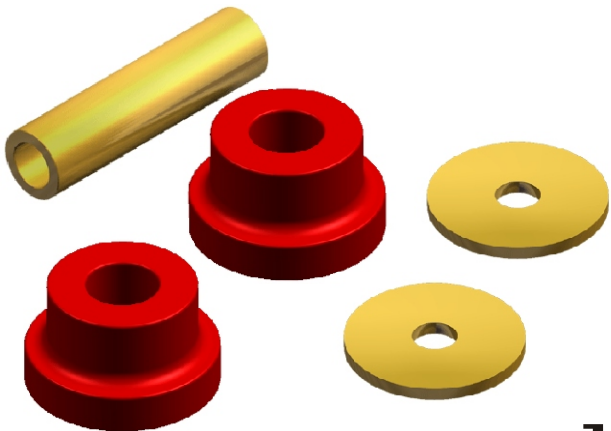

17064

